

FULL MORTISE
SINGLE ACTING SPRING
TEMPLATE HINGE

SIZE: 4 1/2 x 4 --- 4 1/2 x 4 1/2
(114.30 x 101.60) (114.30 x 114.30)

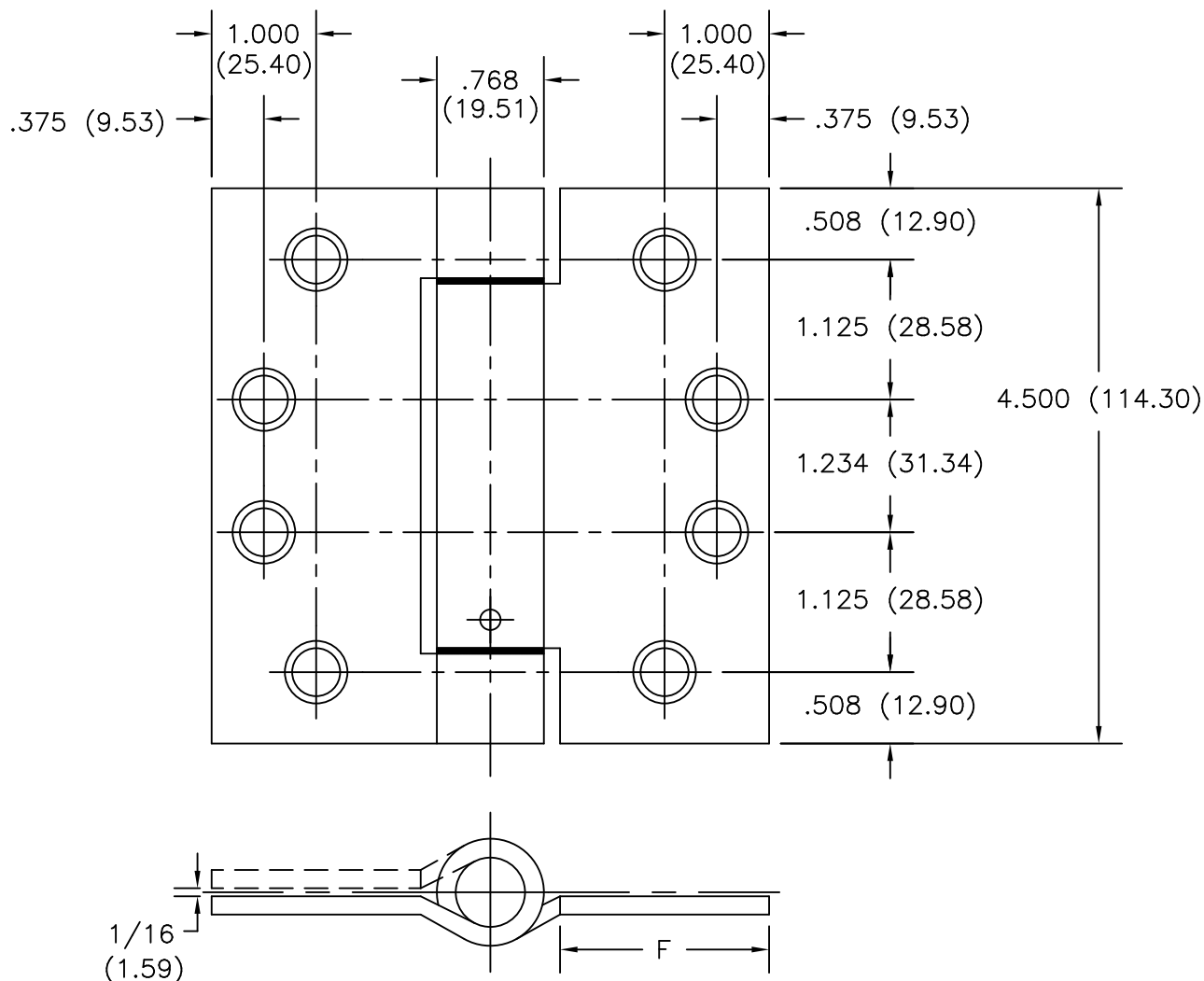

CATALOG NUMBER		(F) DISTANCE FROM EDGE OF LEAF TO SWAGE LINE	(F) DISTANCE FROM EDGE OF LEAF TO SWAGE LINE
STEEL HINGES	METAL GAUGE	4 1/2 X 4 (114.30 X 101.60)	4 1/2 X 4 1/2 (114.30 X 114.30)
EC1105	.134 (3.40)	1 9/16 (39.69)	1 13/16 (46.04)

ALL NON-BRACKETED DIMENSIONS ARE IN INCHES, ALL BRACKETED DIMENSIONS ARE IN MILLIMETERS.

Machine Screw Size— 12-24 x 1/2" F.H.
Wood Screw Size— No. 12 x 1 1/4" F.H.

-DO NOT SCALE-

H
HAGER COMPANIES
139 Victor St.
St. Louis, MO 63104
1-800-325-9995

HAGER RESERVES THE RIGHT TO MAKE DESIGN CHANGES WITHOUT NOTICE.

DESCRIPTION:

ECCO STANDARD WEIGHT
FULL MORTISE TEMPLATE HINGE

NO.	REVISION	BY	DATE
2	UPDATED DWG	DH	01-23-06

PART NO.

T1105