

HALF SURFACE  
SINGLE ACTING  
TEMPLATE HINGE

SIZE: 4 1/2 (114.30)

Template No. T

405

Rev. '96

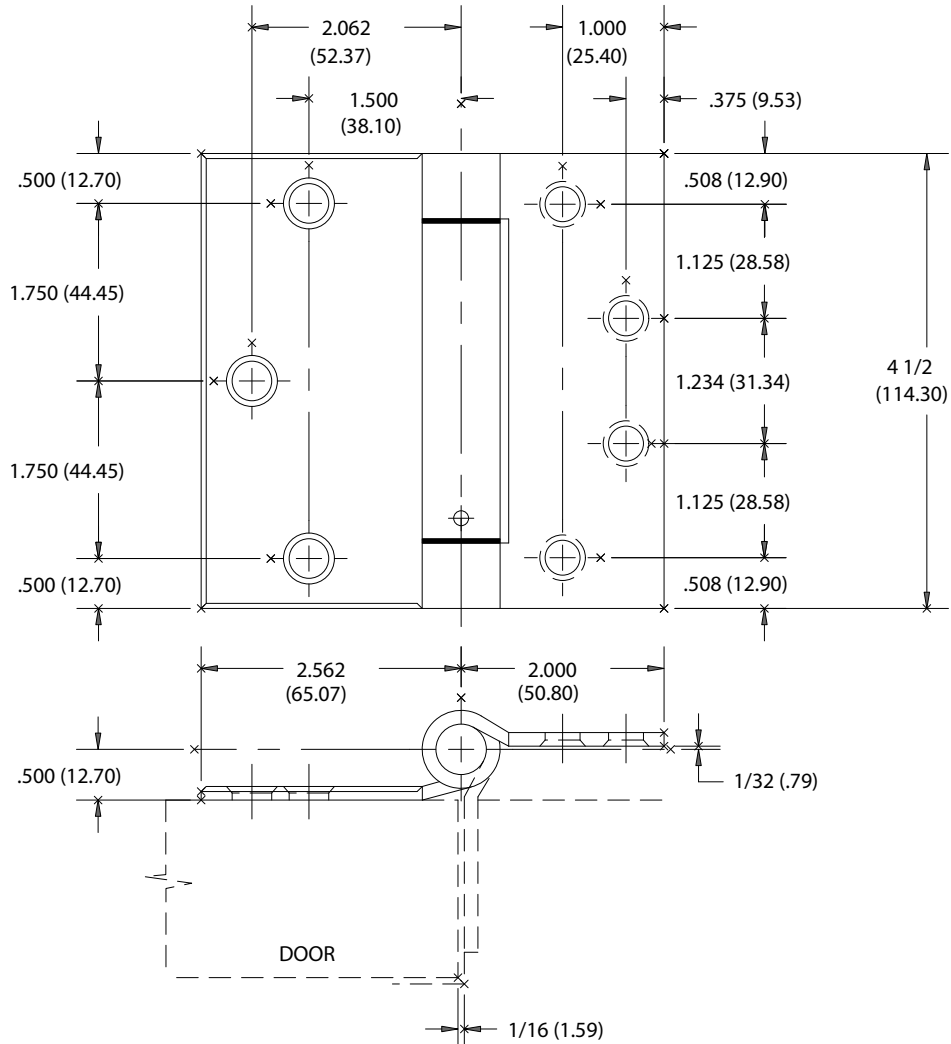

-DO NOT SCALE-

CATALOG NUMBER	
STEEL HINGES	METAL GAUGE
1253	.134 (3.40)

ALL NON-BRACKETED DIMENSIONS ARE IN INCHES, ALL BRACKETED DIMENSIONS ARE IN MILLIMETERS.

Machine Screw Size: Jamb Leaf- 12-24 x 1/2" F.H.

Door Leaf- 1/4-20 x 2" O.H. WITH GROMMET NUTS.

NOTE: Can be used with 4 1/2 (114.30) AB703 or 4 1/2 (114.30) BB1173 (see Template T333).

Hager testing conforms to ANSI-A156.17.

Hager template hinges are made in gauge and with screw holes located to conform to ANSI-A156.7.



HAGER RESERVES THE RIGHT TO MAKE DESIGN CHANGES WITHOUT NOTICE. CALL HAGER ENGINEERING AT 1-800-325-9995 FOR LATEST REVISION DATE OF TEMPLATE.

HAGER COMPANIES  
139 VICTOR STREET  
P.O. BOX 12300  
ST. LOUIS, MISSOURI 63157-0300

Template No. T

405