

FULL MORTISE
REVERSE SAFETY STUD
TEMPLATE HINGES

Template No. T312

| REV. NO. | REVISIONS | BY | DATE |
|----------|-------------|-----|----------|
| 2 | ECO CT05083 | RAM | 12-14-05 |

SIZES: 4 1/2 x 4, 4 1/2 x 4 1/2, 4 1/2 x 5, 4 1/2 x 6,
4 1/2 x 7, 4 1/2 x 8

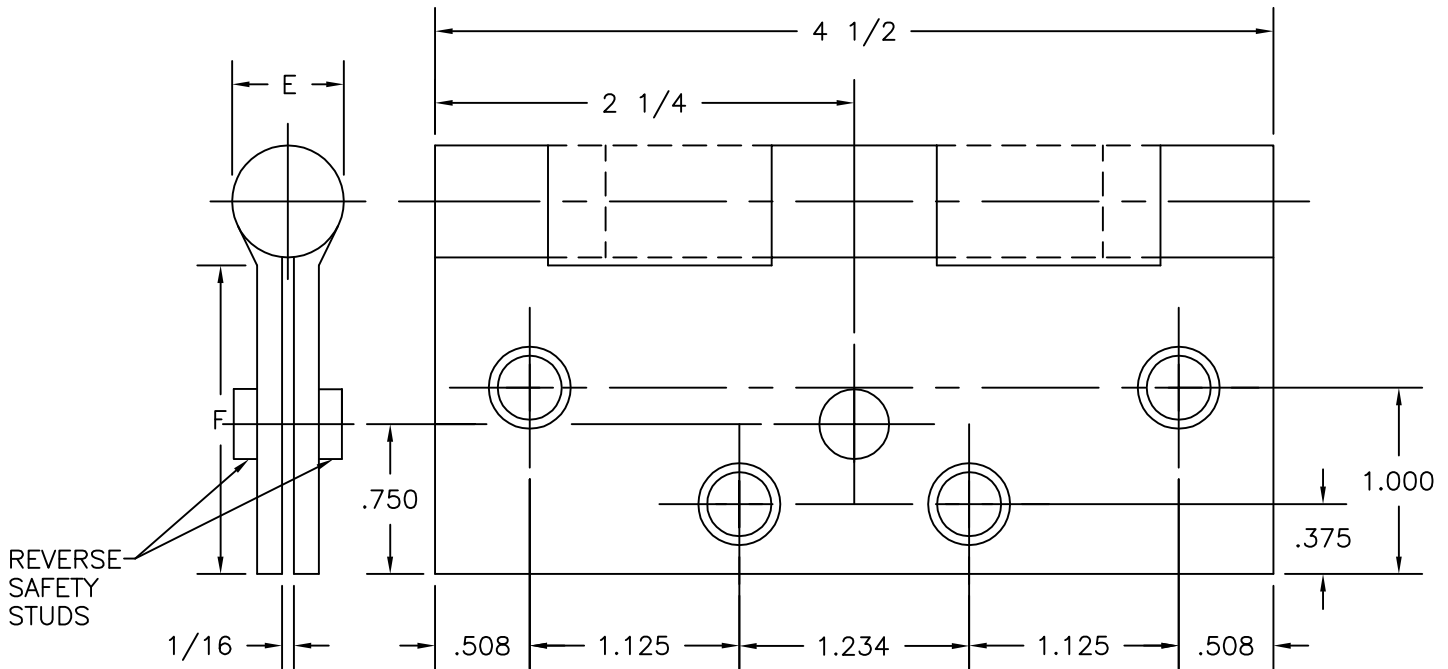

-DO NOT SCALE-

DRILLING INSTRUCTIONS

RECOMMEND ϕ 5/8" HOLES IN JAMB
AND DOOR REINFORCEMENTS FOR
CLEARANCE OF REVERSE SAFETY STUD.

| CATALOG NUMBER | | METAL GAUGE | (E) KNUCKLE DIAMETER | (F) DISTANCE FROM EDGE OF LEAF TO SWAGE LINE | | | | | |
|----------------|--------------------|-------------|----------------------|--|---------------|-----------|-----------|-----------|-----------|
| STEEL HINGES | NON-FERROUS HINGES | | | 4 1/2 x 4 | 4 1/2 x 4 1/2 | 4 1/2 x 5 | 4 1/2 x 6 | 4 1/2 x 7 | 4 1/2 x 8 |
| 700 | 800 | .134 | 39/64 | 1 5/8 | 1 7/8 | --- | --- | --- | --- |
| 1279 | 1191 | .134 | 39/64 | 1 5/8 | 1 7/8 | 2 1/8 | 2 5/8 | 3 1/8 | 3 5/8 |
| AB700 | AB800 | .134 | 39/64 | 1 5/8 | 1 7/8 | --- | --- | --- | --- |
| BB1174 | BB1193 | .134 | 39/64 | 1 3/8 | 1 5/8 | --- | --- | --- | --- |
| BB1279 | BB1191 | .134 | 39/64 | 1 5/8 | 1 7/8 | 2 1/8 | 2 5/8 | 3 1/8 | 3 5/8 |
| AB750 | AB850 | .180 | 45/64 | 1 9/16 | 1 13/16 | 2 1/16 | 2 9/16 | 3 1/16 | 3 9/16 |
| BB1168 | BB1199 | .180 | 45/64 | 1 9/16 | 1 13/16 | 2 1/16 | 2 9/16 | 3 1/16 | 3 9/16 |

ALL DIMENSIONS ARE IN INCHES.

Machine Screw Size- 12-24 x 1/2" F.H.
Wood Screw Size- No. 12 x 1 1/4" F.H.



Hospital type and round corner template hinges conform to the above screw size and location. They are designated by "HT" and "RC" to catalog number.

Hager template hinges are made in size, gauge and with screw holes located to conform to ANSI-A156.7.

HAGER RESERVES THE RIGHT TO MAKE
DESIGN CHANGES WITHOUT NOTICE. CALL
HAGER ENGINEERING AT 1-800-325-9995
FOR LATEST REVISION DATE OF TEMPLATE.

HAGER COMPANIES
139 VICTOR STREET
P.O. BOX 12300
ST. LOUIS, MISSOURI 63157-0300