

REV.	DESCRIPTION	DATE
-	INITIAL CHECK IN	1/16/2014
01	CORRECTED CLEARANCE TO REFLECT A CORRECTION IN VENDOR PRINTS	4/15/2016
02	UPDATED FOR CUSTOMER INQUIRY	6/29/2017

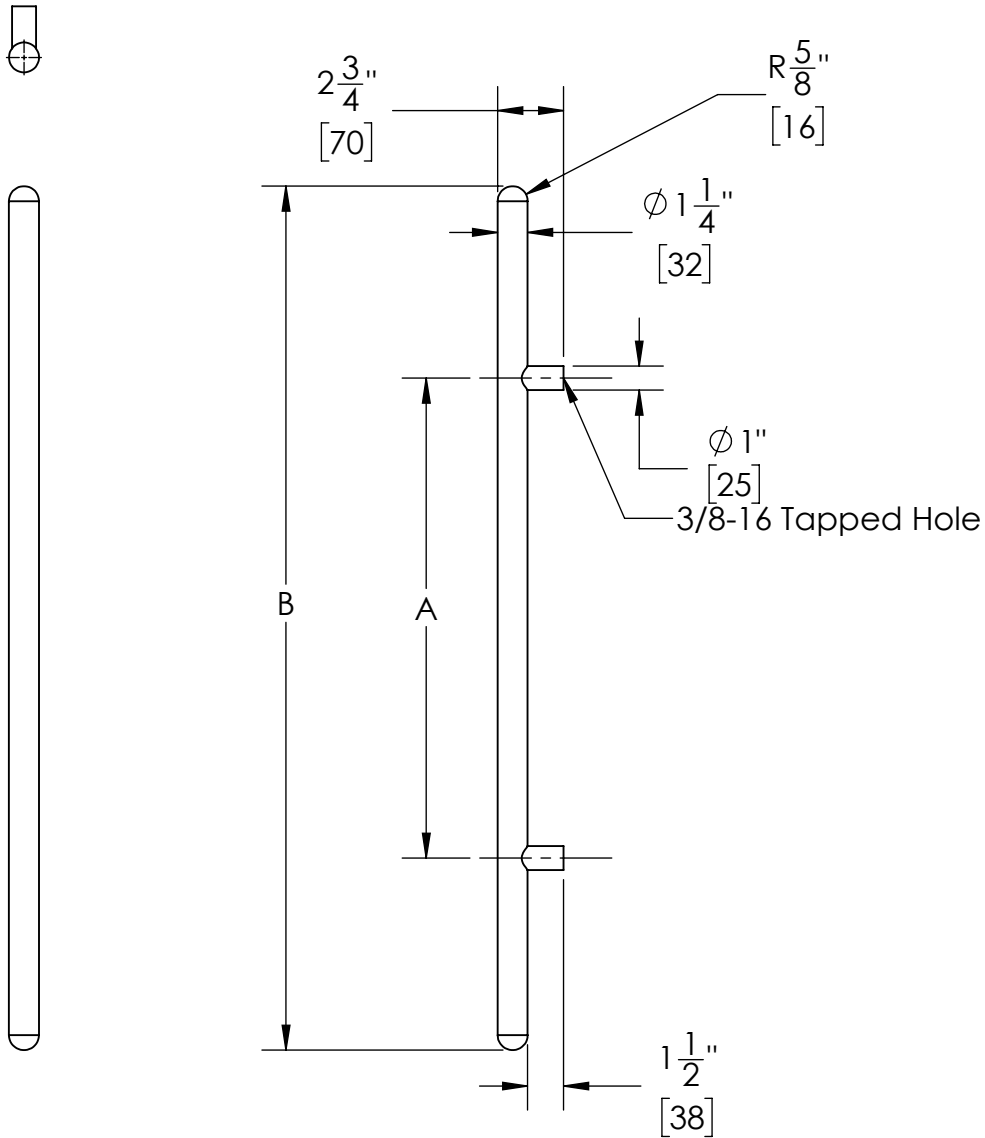

NOTE: FASTENERS

915P (SINGLE): (2) 3/8-16 x 2-1/4" FPHMS WITH FINISH WASHER
 915B (BACK-TO-BACK): (2 SETS) CONCEALED CONE WITH BOLT & SET SCREW

C-T-C	A	B
20	20 [508]	36 [914]
56	56 [1422]	72 [1829]

DIMENSIONS IN [] ARE IN MILLIMETERS



PROPRIETARY & CONFIDENTIAL
 THE INFORMATION CONTAINED IN THIS DRAWING IS THE SOLE PROPERTY OF HAGER COMPANIES. ANY REPRODUCTION IN PART OR AS A WHOLE WITHOUT THE WRITTEN PERMISSION OF HAGER COMPANIES IS PROHIBITED.

HAGER RESERVES THE RIGHT TO MAKE DESIGN CHANGES WITHOUT NOTICE. CALL HAGER ENGINEERING AT 1-800-325-9995 FOR THE LATEST REVISION DATE OF TEMPLATE.

MATERIAL	AISI 304
FINISH	-
DO NOT SCALE DRAWING	

DRAWN	KJW	4/14/2016
ENG. APPR.	MAM	4/15/2016
Q.A.		
TOLERANCES: FRACTIONAL: ±0.015" ANGULAR: MACH: ± 1° BEND: ±1° TWO PLACE DECIMAL: ±0.01" THREE PLACE DECIMAL: ±0.004"		

915P		REV.	02
STRAIGHT MOUNTING VERTICAL PULL (36" OVERALL)			
SIZE	DWG. NO.	S-TA00816	
A			
SCALE: 1:8	WEIGHT: 1.66	SHEET 1 OF 2	

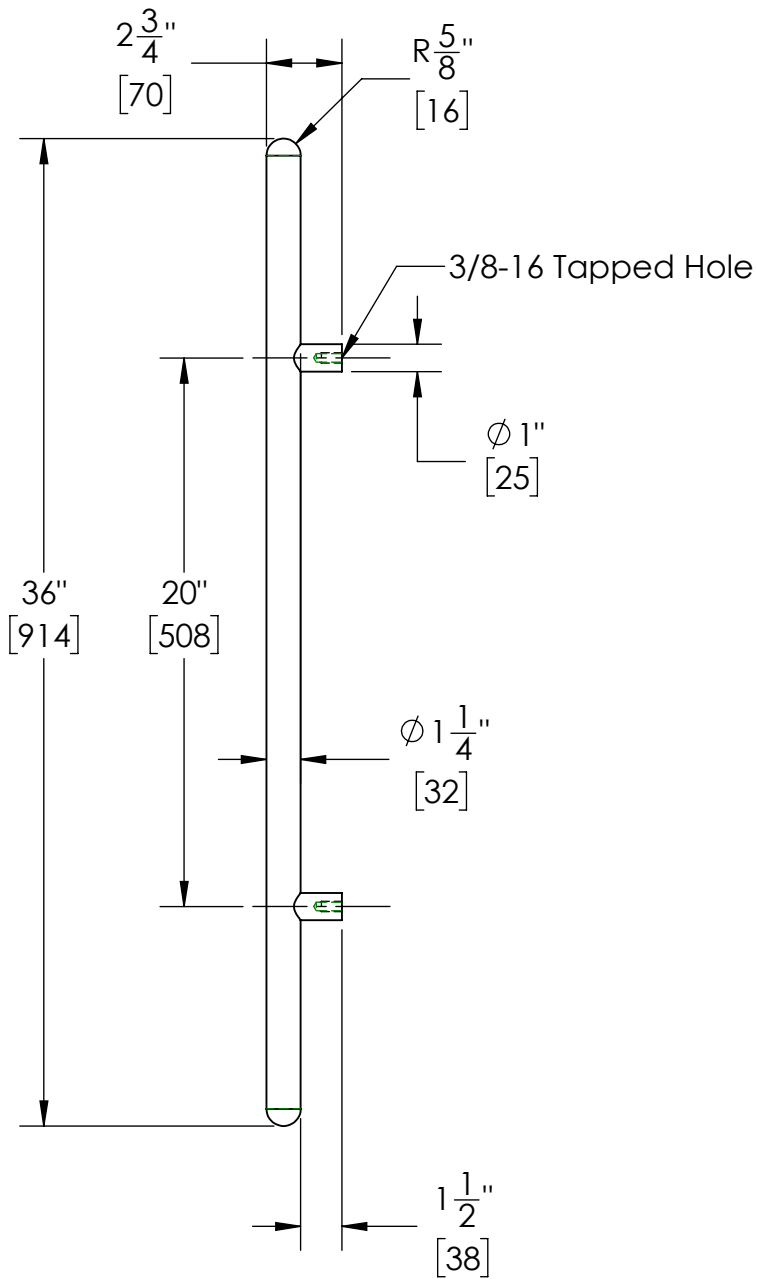

NOTES: (2) 3/8" -16 FPHMS w/Finish Washers Supplied Standard

DIMENSIONS IN [] ARE IN MILLIMETERS



PROPRIETARY & CONFIDENTIAL
 THE INFORMATION CONTAINED
 IN THIS DRAWING IS THE SOLE
 PROPERTY OF HAGER
 COMPANIES. ANY REPRODUCTION
 IN PART OR AS A WHOLE WITHOUT
 THE WRITTEN PERMISSION OF
 HAGER COMPANIES IS PROHIBITED.

HAGER RESERVES
 THE RIGHT TO
 MAKE DESIGN
 CHANGES
 WITHOUT NOTICE.
 CALL HAGER
 ENGINEERING AT
 1-800-325-9995
 FOR THE LATEST
 REVISION DATE
 OF TEMPLATE.

	DRAWN	KJW	4/14/2016
	ENG. APPR.	MAM	4/15/2016
MATERIAL	AISI 304		
FINISH	-		
DO NOT SCALE DRAWING	TOLERANCES: FRACTIONAL: ±0.015" ANGULAR: MACH: ± 1° BEND: ±1° TWO PLACE DECIMAL: ±0.01" THREE PLACE DECIMAL: ±0.004"		

915P		SIZE	DWG. NO.	REV.
STRAIGHT MOUNTING VERTICAL PULL (36" OVERALL)		A	S-TA00816	02
SCALE: 1:16	WEIGHT: 1.66	SHEET 2 OF 2		