

**INSTALL DOOR COORDINATOR PRIOR TO ANY OTHER HARDWARE**

Contents:	Qty:	
1. Door Coordinator	1	
2. Filler Bar (297F)	1	
3. Door Coordinator Strike	2	
4. #12-24 x 1 1/4" PPH Thread Forming Type C Screw	7	
5. #8 x 3/4" FPH Undercut Combo Screw	4	

## 1 Mount the Active and Inactive Door Coordinator Strikes

- Using Figure 1, mark the Door Coordinator Strike mounting holes
- Drill mounting holes on the door
  - For metal doors, tap an 8-32 threaded hole
  - For wood door, drill a 5/64" hole
- Install using 4ea of the #8 x 3/4" FPH Undercut Combo Screws

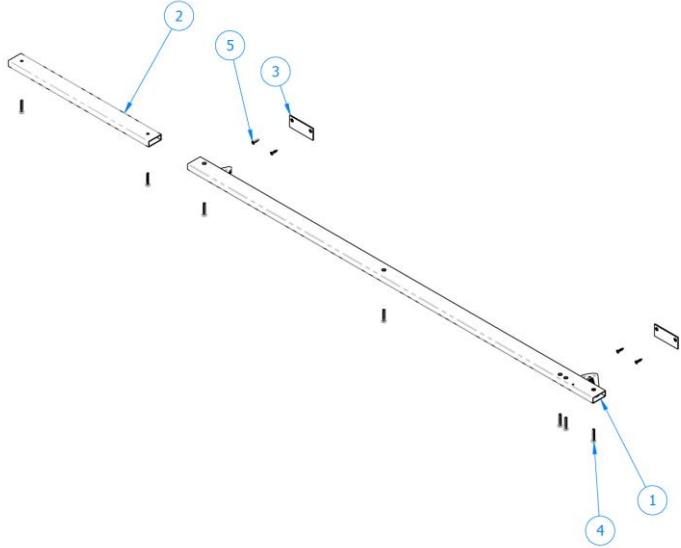
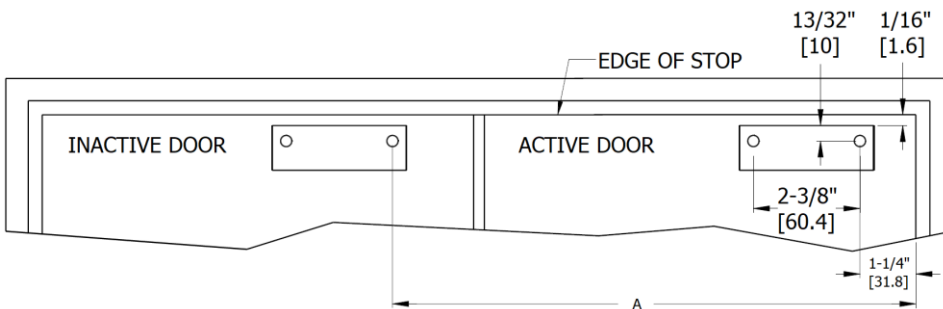

Figure 1

Reversible – RH (LHRB) Shown	
COORDINATOR MECHANISM	A
32" [812.8]	27-1/2" [698.5]
42" [1066.8]	37-1/2" [952.5]
52" [1320.8]	47-1/2" [1206.5]
60" [1524]	55-1/2" [1409.7]
66" [1676.4]	61-1/2" [1562.1]
72" [1828.8]	67-1/2" [1714.5]

## 2 Mount the Door Coordinator

- Press the Trigger and then the Lever
- Place the Coordinator against Soffit and Door Coordinator Strikes as seen in Figure 3.
- Mark the center mounting hole
- Using a #10 drill bit, drill through the mark made in the previous step
- Mount the Coordinator to the Soffit with 1ea #12-24 x 1 1/4" PPH Thread Forming Type C Screw

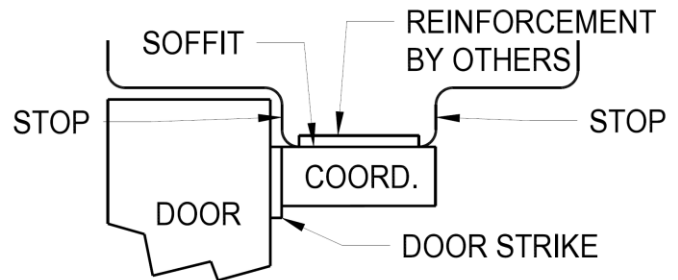

Figure 2: Side View

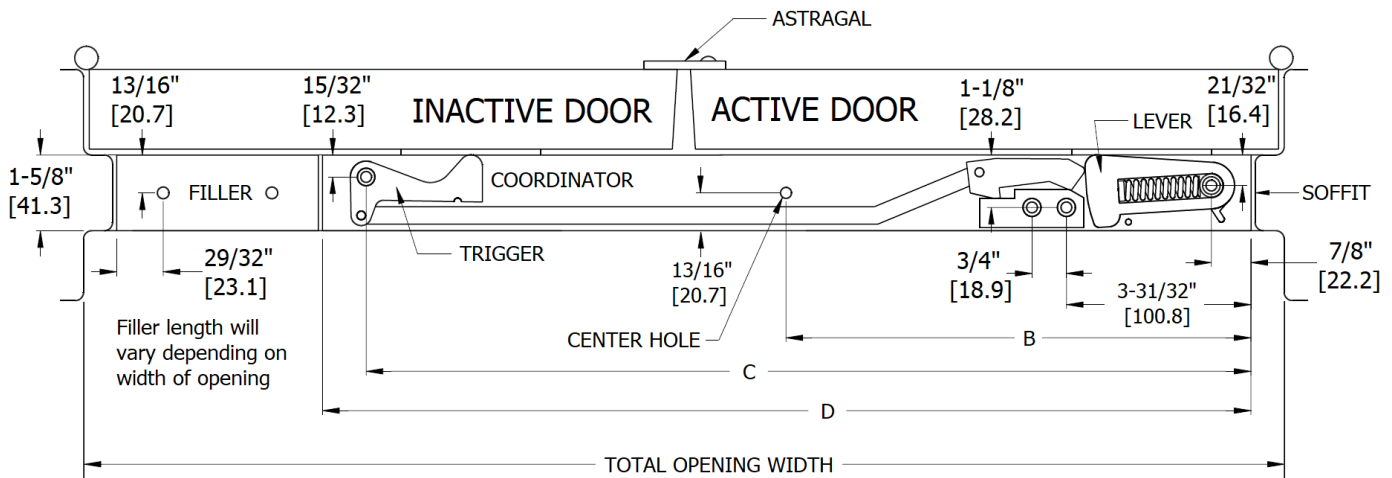

Figure 3: Top View

- Close the doors to ensure the Coordinator is resting against both Door Coordinator Strikes
- Mark the four remaining mounting hole locations
- Using a #10 drill bit, drill through the marks made in the previous step
- Mount the Coordinator to the Soffit with 4ea #12-24 x 1 1/4" PPH Thread Forming Type C Screw

Note: Filler bars will fill the void between the Coordinator and Soffit. Filler bars mount the same as the Coordinator.

COORDINATOR MECHANISM	B	C	D
32" [812.8]	16" [406.4]	31" [787.3]	32" [812.8]
42" [1066.8]	21" [533.4]	41" [1041.3]	42" [1066.8]
52" [1320.8]	27-5/8" [701.7]	51" [1295.3]	52" [1320.8]
60" [1524]	27-5/8" [701.7]	59" [1498.5]	60" [1524]
66" [1676.4]	27-5/8" [701.7]	65" [1650.9]	66" [1676.4]
72" [1828.8]	35-31/32" [914]	71" [1803.3]	72" [1828.8]

### **3 Test the Door Coordinator and adjust**

- Test the operation by opening both doors and letting the Active Door to close first. The Active Door should be held open until the Inactive Door closes.
- If the Coordinator overrides causing the Active Door to close prior to the Inactive Door, **ADJUST DOOR CLOSER SPEEDS FIRST**
- If the Coordinator still overrides, adjust the tension on the Override Mechanism by using a #1 Philips Head Screwdriver. Turn the screw in the lever end clockwise as seen in Figure 4.

NOTE: If the lever and/or trigger does not return to the extended position after both doors are opened, the mounting screws thru the lever and/or trigger may be too tight. Back the screws off 1/4 turn until the lever and/or trigger return to the extended position.

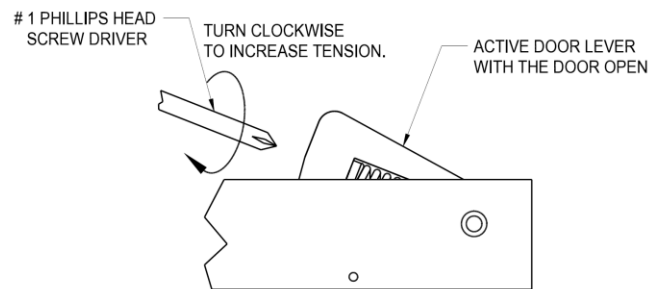

Figure 4: Override Mechanism