

FUNCTION DESCRIPTION

3480EL - Fail Safe Control [GREEN]

Outside trim is locked when power is applied and unlocked when power is removed (storeroom function when energized). Lockset will unlock in the event of a power failure.

3480EU - Fail Secure Control [YELLOW]

Outside trim is unlocked when power is applied and locked when power is removed. Lockset will lock in the event of a power failure. This is the default lock setup.

Key Function

When key cylinders are installed into locks, the latch bolt may be momentarily retracted from the outside with key even if lockset is electrically locked.

Request to Exit

Request to Exit (RX) is a SPDT switch that is mounted inside the interior trim of the lockset. The RX switch monitors the activation of the inside trim.

ELECTRICAL SPECIFICATIONS

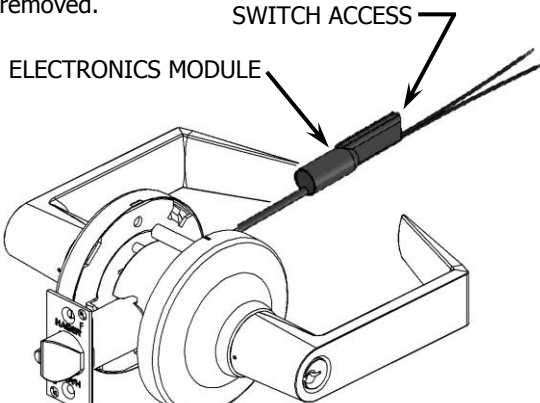
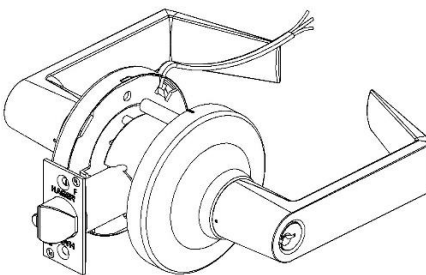
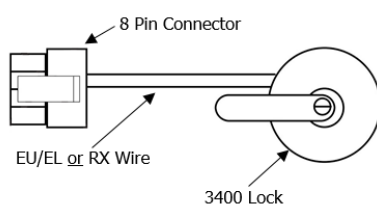
3480EL and 3480EU	3480RX	Quick Connect Pin Assignments																						
<p>Motorized Locking and Unlocking provides 12V/24V Fail-Safe/Fail-Secure operation with low power consumption.</p> <p>Voltage: 12-24V AC/DC (11V – 30V) Current: 250 mA MAX Inrush, 10 mA MAX Holding Non-polarized leads Fail-Secure (EL) by Default</p> <table border="1"> <thead> <tr> <th align="center" colspan="2">2-Conductor Wire Run</th> </tr> <tr> <th align="center">Distance 12V/24V</th> <th align="center">Wire Gauge</th> </tr> </thead> <tbody> <tr><td align="center">125'/250'</td><td align="center">22</td></tr> <tr><td align="center">200'/400'</td><td align="center">20</td></tr> <tr><td align="center">300'/600'</td><td align="center">18</td></tr> <tr><td align="center">500'/1000'</td><td align="center">16</td></tr> <tr><td align="center">750'/1500'</td><td align="center">14</td></tr> <tr><td align="center">1250'/2500'</td><td align="center">12</td></tr> </tbody> </table> <p>Note: Warranty is void if electronics module is removed.</p> 	2-Conductor Wire Run		Distance 12V/24V	Wire Gauge	125'/250'	22	200'/400'	20	300'/600'	18	500'/1000'	16	750'/1500'	14	1250'/2500'	12	<p>SPDT mechanical switch. Mainly used as a dry contact monitoring switch.</p> <table border="0"> <thead> <tr> <th align="left">Voltage</th> <th align="left">Current</th> </tr> </thead> <tbody> <tr> <td>125 VAC</td> <td>3 AMP</td> </tr> <tr> <td>30 VDC</td> <td>2 AMP</td> </tr> </tbody> </table> <p>RX Wiring Diagram Yellow Wire: (common) Red Wire: (normally open) Gray Wire: (normally closed)</p> 	Voltage	Current	125 VAC	3 AMP	30 VDC	2 AMP	<p>EU/EL or RX only</p> <ul style="list-style-type: none"> - If the lock only has EU/EL or RX electric function the function will be wired directly into an 8 pin connector as shown in the image below. The 8 pin connector can be plugged directly into a Hager Quick Connect Harness Cable during installation of the lock. - Insert excess wire into the raceway prior to installing the lock body. - See wire color reference charts on page 2 to complete wiring of full door assembly. 
2-Conductor Wire Run																								
Distance 12V/24V	Wire Gauge																							
125'/250'	22																							
200'/400'	20																							
300'/600'	18																							
500'/1000'	16																							
750'/1500'	14																							
1250'/2500'	12																							
Voltage	Current																							
125 VAC	3 AMP																							
30 VDC	2 AMP																							

EU/EL and RX

- If the lock has both EU/EL and RX the EU/EL power wires will have an inline connector that is attached to an 8 pin connector and the RX will be connected directly to the 8 pin connector.
- The inline connector must be connected through the 2-1/8" hole in the door to be able to fully install the lock. See image below for reference.
- Insert excess wire into the raceway prior to installing the lock body.
- See wire color reference charts on this page to complete wiring of full door assembly.

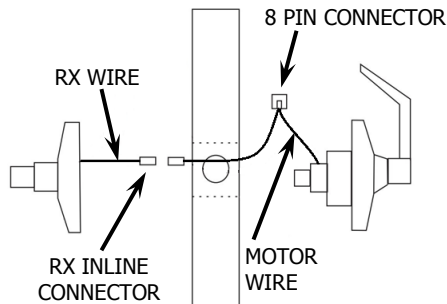

WIRE COLOR REFERENCE CHART

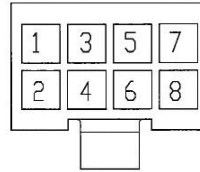

8-Pin Housing Wire Positions:
 EU/EL: (1) BLUE, (2) BLUE
 RX: (3) YELLOW, (4) RED, (5) GRAY
 (6), (7), & (8) UNASSIGNED

Selecting Fail-Safe (EL) / Fail Secure (EU)

Move Switch Slider to desired function setting as shown below to select 3480EL (GREEN) or 3480EU (YELLOW). Power must be applied to the unit once after moving the switch to change the lockset's state.

NOTE: The colors indicate which direction to move the switch to select the desired function. They are not position indicators. The switch should be easy to move, so don't force it.

YELLOW: FAIL SECURE (3840EU)
 GREEN: FAIL SAFE (3840EL)

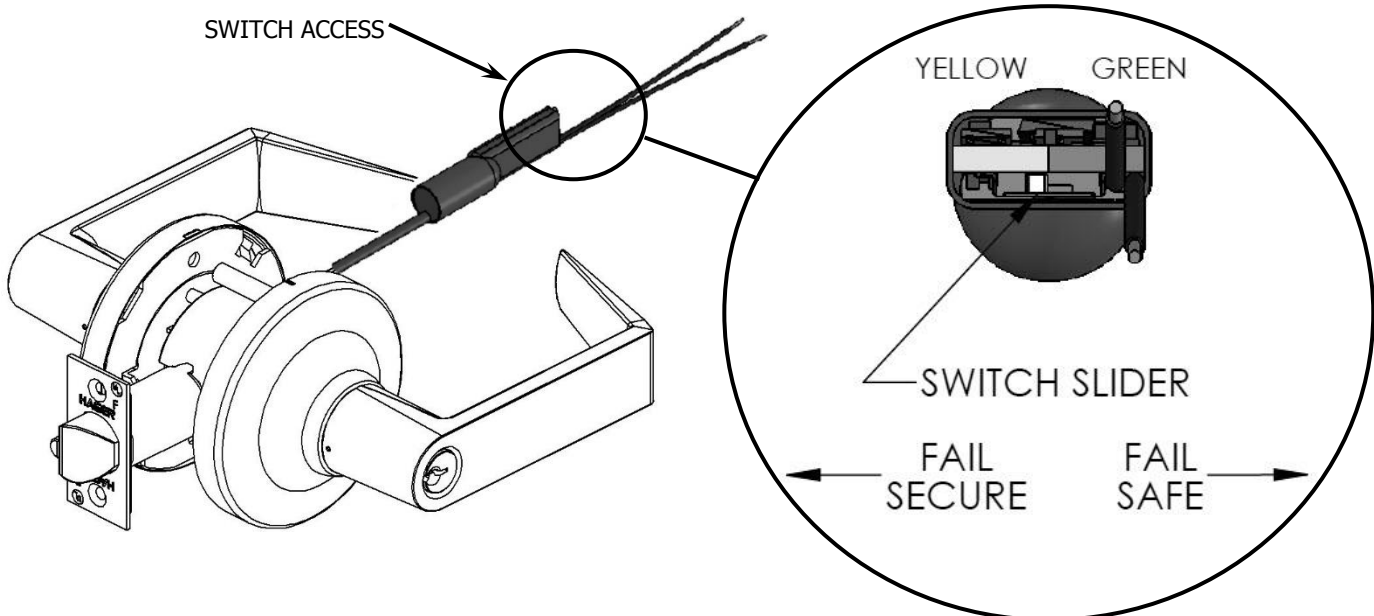

INSTRUCTIONS

Door and Frame Preparations

1. Use standard instructions and template to prepare door for lock installation.
2. Door fabricator to provide a 3/4" diameter hole extending 4-3/4" in depth from back edge of 2-1/8" diameter cross bore hole. This provides room for insertion of the electronics module and wires. For cylindrical locks that only have request to exit (part number 3480RX), this section of the raceway shall be 3/8" diameter to match Step 3 shown below.
3. Raceway can then be reduced to 3/8" diameter and continue through door to allow insertion of the electronics module and wires running between lock and electric hinge.
4. Provide mortised 3/4" diameter cutout on inside face of door for wire entry access to raceway.

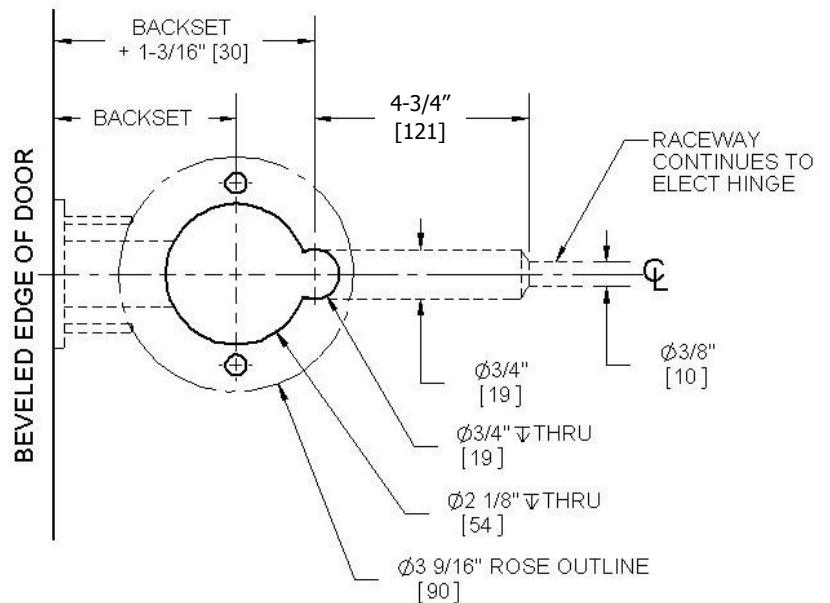
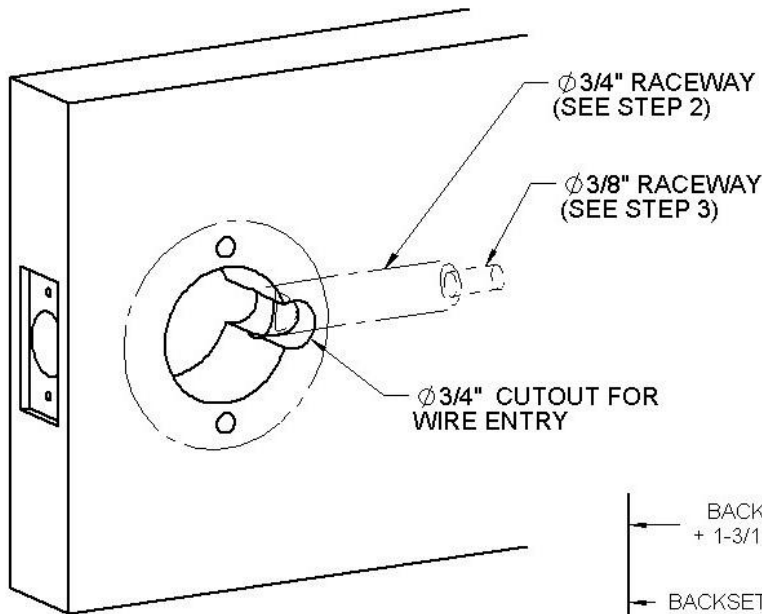

DIMENSIONS IN [] ARE IN MILLIMETERS